

This drawing is the property of Bradley Murphy Design Ltd. Copyright is reserved by them and the drawing is issued on the condition that it is not copied, reproduced, retained nor disclosed to any unauthorized person either wholly or in part without the consent of Bradley Murphy Design Ltd.

NOTES:

1. THIS DRAWING IS BASED ON PBA DRAWINGS; COMMUNITY STREET GA 2417/2034/100-C
2. THIS DRAWING SHOULD BE READ IN CONJUNCTION WITH ALL OTHER LANDSCAPE DRAWINGS AND DOCUMENTS
3. THIS DRAWING IS NOT INTENDED FOR CONSTRUCTION
4. DO NOT SCALE FROM THIS DRAWING
5. ANY DISCREPANCIES WITHIN THIS DRAWING OR BETWEEN THIS DRAWING AND ANY OTHER INFORMATION IS TO BE REPORTED TO BMD FOR CLARIFICATION
6. LEVELS PROVIDED ON THIS DRAWING ARE INCLUDED FOR INFORMATION ONLY

- BOUNDARIES**
- POCKET SQUARE APPLICATION BOUNDARY
- LEVELS & DRAINAGE**
- PROPOSED LEVELS - REFER TO PBA FOR FURTHER DETAILS
  - LEVELS OUTSIDE APPLICATION BOUNDARY OR AS PART OF SEPARATE PLANNING APPLICATION PACK
  - SLOT DRAIN - REFER TO PBA DETAIL AND SPECIFICATION
- HARD LANDSCAPE**
- PAVING - WIENERBERGER BASALT WF, GREY & DARK GREY MIX, STRETCHER, 200MM X 40MM X 85MM
  - PAVING - MARSHALLS KEYBLOK, MARI GOLD, STRETCHER BOND, 200MM X 100MM X 80MM
  - PAVING BANDS - WIENERBERGER NERO DF, DARK GREY SANDED STRETCHER BOND, 200MM X 64MM X 85MM, SNO. ROWS
  - FLUSH KERB TO PLANTER EDGE - WIENERBERGER NERO DF, DARK GREY SANDED ROWLOCK COURSE 200MM X 64MM X 85MM
  - PLANTER WALLS, 450MM HIGH, 215MM WIDE, FACED WITH STAFFORDSHIRE BLUE BRICK SLIPS
- STREET FURNITURE**
- WALL MOUNTED BENCH - WOODSCAPE CLIFTON
  - WALL 450MM WIDE UNDER BENCH REFER TO PLAN ANNOTATION FOR BENCHES WITH BACK AND ARM RESTS
  - LIGHTING COLUMN HOLOPHANE VMAX TO MATCH COMMUNITY STREET FITTINGS, MOUNTED ON A STANDARD COLUMN, WITH A BLACK FINISH - NUMBER AND LOCATION TO BE CONFIRMED BY PBA
  - FINGER SIGN POST - BESPOKE SIGNAGE BY PLACEMARQUE WITH STAINLESS STEEL OR BRUSHED FINISH
  - BOLLARD - TO MATCH BOLLARD USED ON DISTRICT CENTRE EAST BRIDGE LANDING
  - BN - CITY SQUARED BASIC LITER BN 4100, 495MM X 1115MM, BASE PLATE BELOW GROUND FINING OR SIMILAR
  - FEEDER PILLAR - REFER TO PBA DETAIL AND SPECIFICATION
- ARTWORK TO BE INCORPORATED INTO PROPOSALS - SCOPE TO BE CONFIRMED**
- SOFT LANDSCAPE**
- PROPOSED TREES - REFER TO PLANTING PLAN BMD.17.013.PS.DR.P301 & 302
  - ORNAMENTAL SHRUB PLANTING TO APPROACH PATH REFER TO PLANTING PLAN BMD.17.013.PS.DR.P301 & 302
  - ORNAMENTAL PLANTING TO THE SQUARE - REFER TO PLANTING PLAN BMD.17.013.PS.DR.P301 & 302
  - NEIGHBOURING HEDGE
  - STRUCTURAL SOIL TREE PIT EXTENT - REFER TO TREE PIT DETAIL BMD.17.022.PS.DR.P601-02

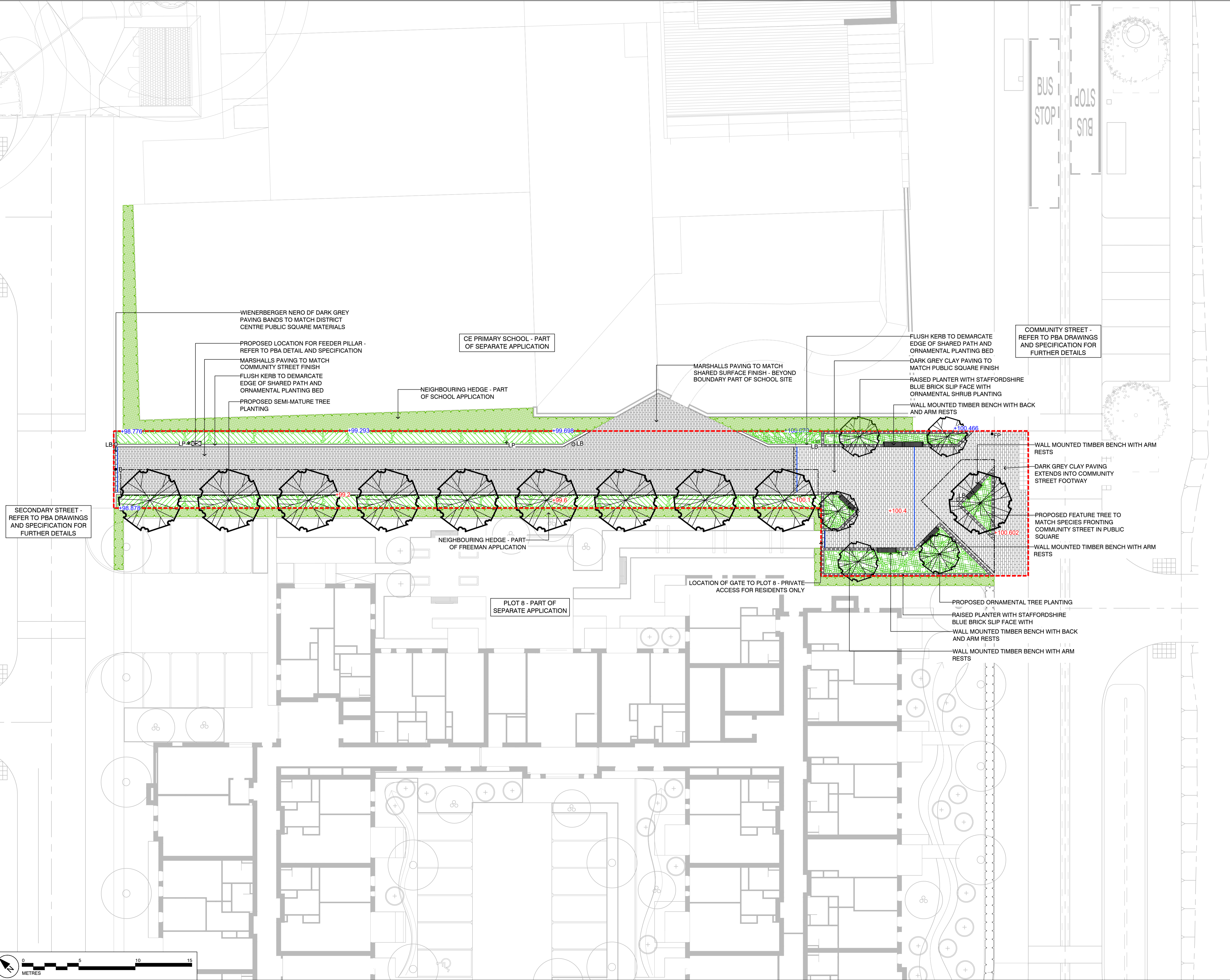

SECONDARY STREET - REFER TO PBA DRAWINGS AND SPECIFICATION FOR FURTHER DETAILS

CE PRIMARY SCHOOL - PART OF SEPARATE APPLICATION

COMMUNITY STREET - REFER TO PBA DRAWINGS AND SPECIFICATION FOR FURTHER DETAILS

NEIGHBOURING HEDGE - PART OF FREEMAN APPLICATION

PLOT 8 - PART OF SEPARATE APPLICATION

LOCATION OF GATE TO PLOT 8 - PRIVATE ACCESS FOR RESIDENTS ONLY

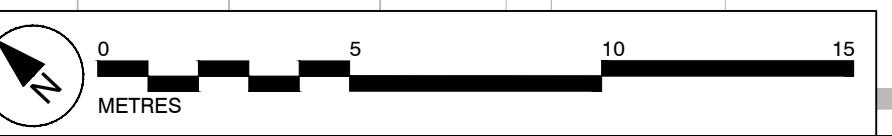

Rev	Description	Date	
A	MINOR AMENDS	19/02/19	
Purpose of Issue			
<b>PLANNING</b>			
Bradley Murphy Design Ltd 5 The Courtyard Hatton Technology Park Dark Lane Hatton Warwickshire CV35 8XB			
t: 01926 676496 e: info@bradleymurphydesign.co.uk www.bradleymurphydesign.co.uk			
Client			
<b>SWINDON BOROUGH COUNCIL</b>			
Project			
WICHELSTOWE, SWINDON			
Drawing Title			
DC POCKET SQUARE, GENERAL ARRANGEMENT			
Drawn	Checked	Approved	Date
EP	JL	RW	27/11/2018
Job No.	Scale	Sheet Size	Revision
BMD.17.013	1:150	A1	A
Drawing Number			
BMD.17.013.PS.DR.P001			